



## The Phillips



### The Phillips Model number: 22MAC16562AH20

**2 beds • 2 baths • 896 sq.ft. • 16' width • 56' depth**

Our home building facilities invest in continuous product and process improvements. Plans, dimensions, features, materials, specifications and availability are subject to change without notice or obligation. Renderings and floor plans are representative likenesses of our homes and may differ from the actual homes. We invite you to tour a Home Center near you and inspect the highest value in quality housing available or call (606) 638-4663 to speak with a Home Consultant. Copyright 2017, CMH. All rights reserved.

<https://www.claytonhomeslouisia.com>

### CLAYTON HOMES-LOUISA

17151 HWY 23  
LOUISA, KY 41230

Monday - Thursday: 9am to 6pm  
Friday: 9am to 6pm  
Saturday: 9am to 5pm  
Sunday: Closed

(606) 638-4663



# The Phillips

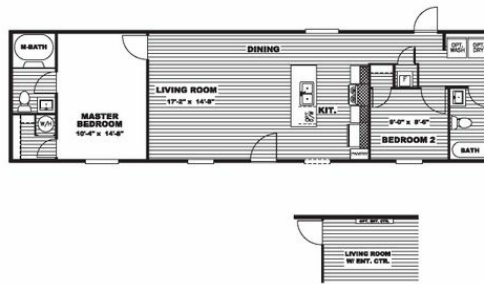

Model # MAC16562A  
Series #  
7251 G1  
16' x 56' MAC

## The Phillips

Model number: 22MAC16562AH20

**2 beds • 2 baths • 896 sq.ft. • 16' width • 56' depth**

Our home building facilities invest in continuous product and process improvements. Plans, dimensions, features, materials, specifications and availability are subject to change without notice or obligation. Renderings and floor plans are representative likenesses of our homes and may differ from the actual homes. We invite you to tour a Home Center near you and inspect the highest value in quality housing available or call (606) 638-4663 to speak with a Home Consultant. Copyright 2017, CMH. All rights reserved.

<https://www.claytonhomeslouisia.com>

## CLAYTON HOMES-LOUISA

17151 HWY 23  
LOUISA, KY 41230

Monday - Thursday: 9am to 6pm  
Friday: 9am to 6pm  
Saturday: 9am to 5pm  
Sunday: Closed

(606) 638-4663